

Socially Guided Observational Learning: Children Learn More From Overheard Speech When It's Addressed to Their Mothers

SARAH GOODMAN, ISHA RAWAL, RUTHE FOUSHEE

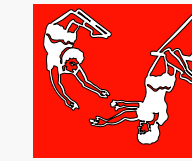

THE NEW SCHOOL FOR SOCIAL RESEARCH

BACKGROUND

- Child-directed speech (CDS) is thought of as the gold-standard of input for language-acquisition.
- Yet in contexts where direct address is rare, children acquire language almost entirely through observation.^{1,2,3,4}
- *When does overheard speech become usable language-learning input?*
- Existing work focuses primarily on cognitive and developmental factors.⁵
- Our focus: Children's close social partners, by attracting their attention,⁶ may determine which overheard conversations become meaningful sites of learning.

METHOD

Participants

- 75 mother-child dyads from Chiapas, Mexico.
- Final sample: $N = 68$ [10–41 months, $M = 28.38$, $SD = 7.51$].

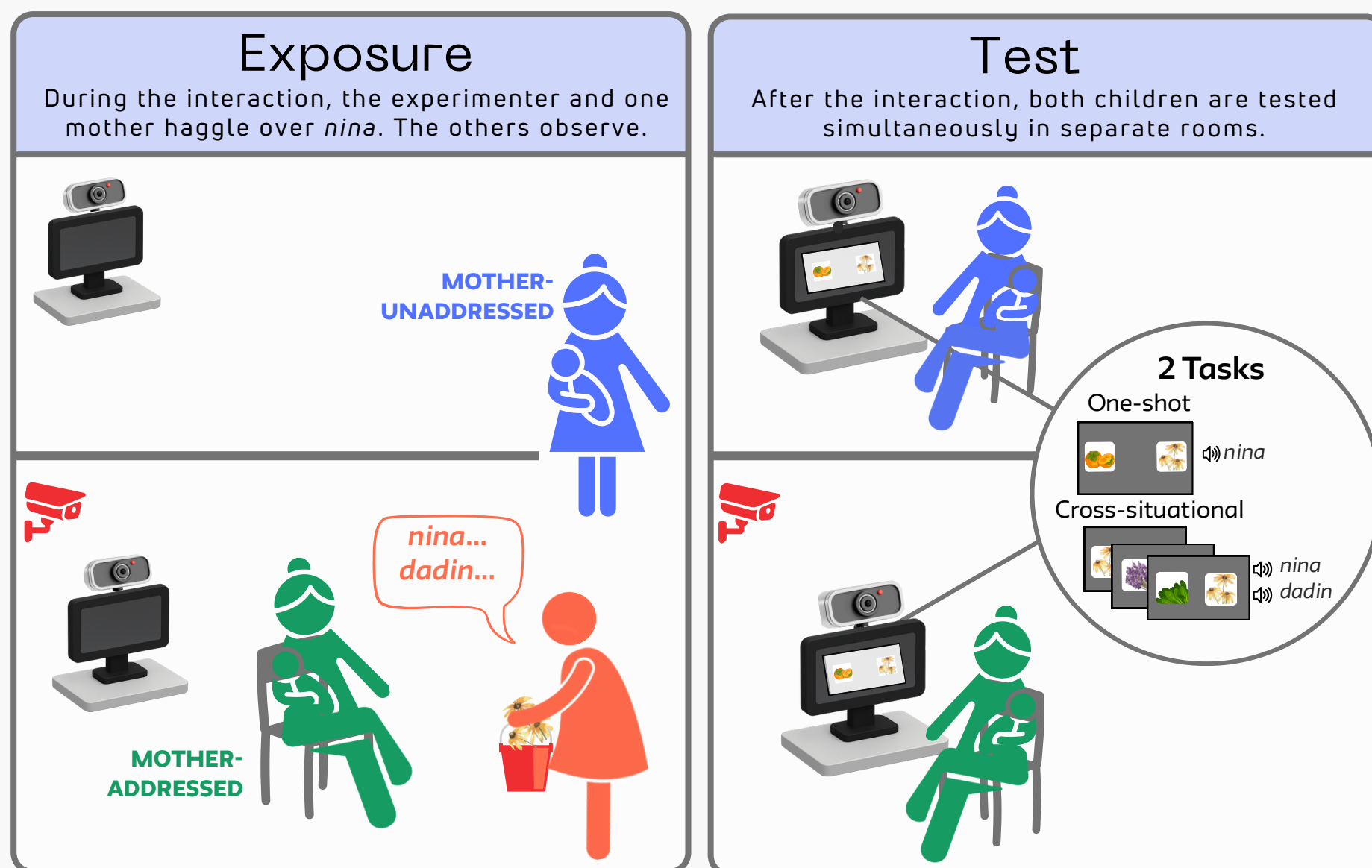

Coding and Variables

- Videos of children's gaze were recorded for later coding of left/right looking time.
- Proportion of target-looking time is used to index word-recognition.^{7,8}

STIMULI

One-Shot
Children view side-by-side images of *nina* (right) and a distractor, while audio asks 'where is the *nina*?'

🔊 Banti ay te *nina*?

Cross-Situational
Over 28 trials, children view ambiguous pairs of images drawn from the novel words used in the interaction (*nina*, *dadín*) and two more novel words (*soman*, *tani*).

HYPOTHESES

- H1:** All children will learn all four words by the end of test.⁷
- H2:** Close social partners attract attention, creating early learning advantages for Mother-Addressed children.

Predictions

- Mother-Addressed children will show greater one-shot recognition of the novel word *nina*, and
- Earlier evidence of cross-situational learning.⁹
- By the end of training, both groups will show above chance recognition of all four words.

RESULTS

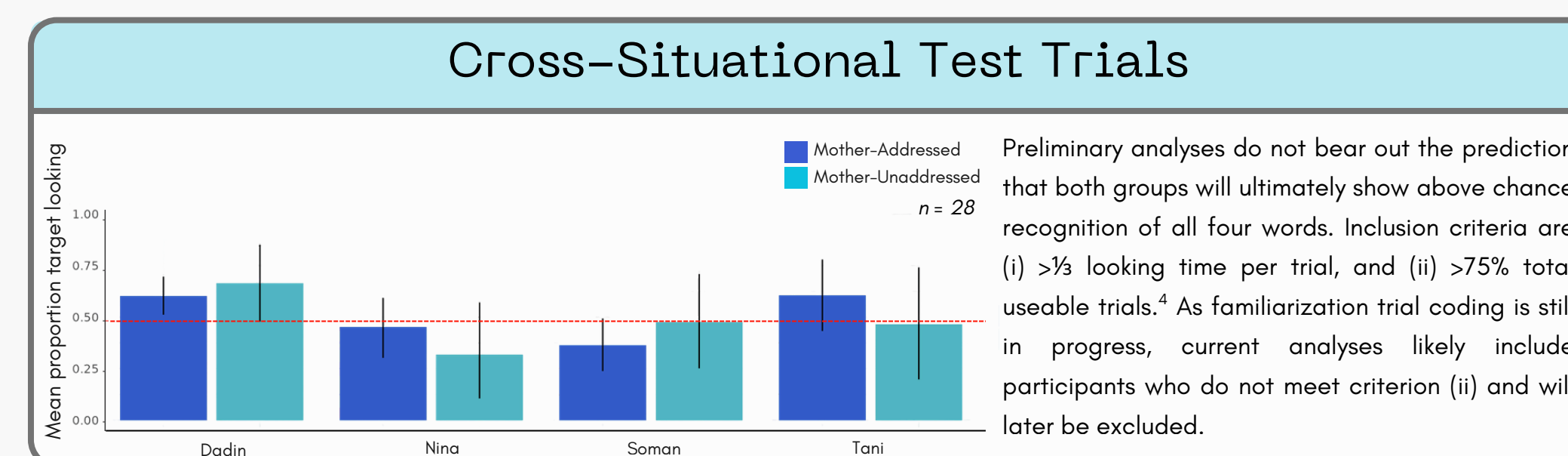
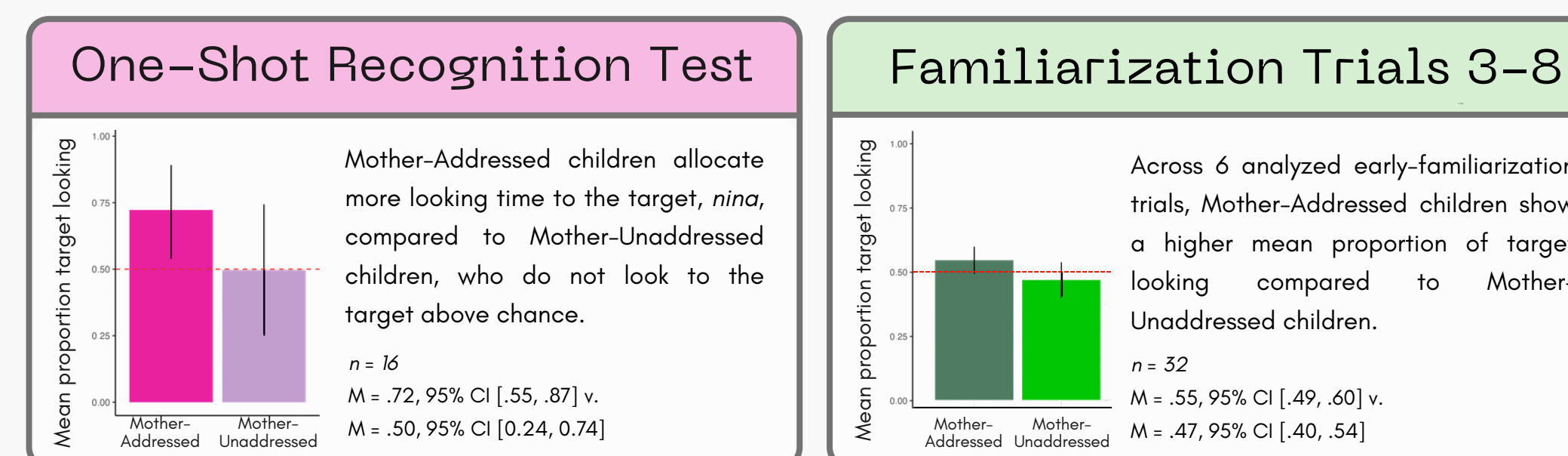

DISCUSSION

- Results challenge accounts of Tselal children as 'expert' overhearers whose learning is not generalizable evidence of the contribution of overheard input to language-acquisition.¹⁰
- Instead, Mother-Addressed Tselal children had significant advantages over Mother-Unaddressed children, who did not show word-recognition above chance.
- This suggests social relationships structure observational learning.

FUTURE DIRECTIONS

- Measure attention directly using (i) gaze-data from interaction videos and (ii) physiological measures of attention to speech.¹¹
- Analyze interactions to examine unaddressed mothers' attention, qualities of experimenter-mother interaction, and their relationship to children's learning.
- Investigate if social closeness boosts attention not only to the interaction but also during tasks.
- Further research should establish whether social closeness similarly structures observational learning in CDS-rich environments where its role is likely underestimated.

ACKNOWLEDGEMENTS

Many thanks to participating families in Tenejapa, to Petrona Girón López and Miko Eugenio for assistance with data collection, and to Alicia Kim, Saina Aryanejad and Omer Raz for coding. Special thanks to Anna Mercier for specialized laboratory support.

REFERENCES

1. De León, L. (2011). Language socialization and multiparty participation frameworks. *Wiley-Blackwell*.
2. Brown, P. (2014). Language acquisition and language socialization. *Cambridge University Press*.
3. Casillas, M., & Brown, P. (2019). Early language experience in a Tselal Mayan village. *Child Development*.
4. Foushee, R., & Srinivasan, M. (2024). Infants who are rarely spoken to nevertheless understand many words. *PNAS*.
5. Foushee, R. (2016). Lexical complexity of child-directed and overheard speech: Implications for learning. *Proc. Cog. Sci.*
6. Thomas, A. (2022). Infants infer potential social partners by observing the interactions of their parent [...]. *PNAS*.
7. Smith, L., & Yu, C. (2008). Infants rapidly learn word-referent mappings via cross-situational statistics. *Cognition*.
8. Golinkoff, R. (1987). The eyes have it: Lexical and syntactic comprehension in a new paradigm. *Journal of Child Language*.
9. Trueswell, J. (2013). Propose but verify: Fast mapping meets cross-situational word learning. *Cognitive Psychology*.
10. Correa-Chávez, M., & Rogoff, B. (2009). Children learn by observing and pitching in. *Developmental Psychology*.
11. Divjak, D. (2024). Physiological responses and cognitive behaviours [...]. *Journal of Neurolinguistics*.